

Auction - Sept. 1919

3,510 ACRES

Terrace Houses.

LOT 5 - FARM OF J. DAVIES - 67 ACRES £1000

Claxby.

LOT 6 - IVY COTTAGE GEO. ELLERBY - 23 ACRES £400

LOT 7 - PELHAM ARMS FARM OF GEO. SHARPE (23 YRS TENANCY) 45 ACRES. WITHDRAWN AT £620

Scale 1/2500

FEET 100 0 100 200 300 400 500 600 FEET

LOT 8 - THE GRANGE FARM J. BURWELL - 321 ACRES. WITHDRAWN AT £3250.

LOT 9 - THE MOAT FARM 123 ACRES - £1400

LOT 16 - THE OLD MILL IN USSELBY + A COTTAGE 2.2 ACRES £135

LOT 19 - ACRE HOUSE FARM - NORMANBY 354 ACRES LEWOLD

LOT 1 - COTTAGE FARM & LINGHAM FARM - 115 ACRES TENANT CHARLES HEWITT BOUGHT BY JOHN GEORGE JOHNSON BLACKSMITH £1700

LOT 2 - CLAXBY HOUSE FARM HOUSE 7 BRMS, FOREMAN'S USE COTTAGES - 566 ACRES. TENANT & BUYERS - WILDSMITH

LOT 3 - MAULTBYS "A" FARM FARMHOUSE + 2 COTTAGES TENANTS & BUYERS - MAULTBY 200 ACRES IN FAMILY FOR 50 YRS

LOT 4 - MAULTBYS "B" FARM COTTAGE TENANTS & BUYERS - MAULTBY 71 ACRES. £1400

LOT 10 - THE SMITHY & POST OFFICE TENANT - SHEPHERD BRISTOWE 14 ACRES LIVED THERE FOR 40 YEARS

LOT 11 - PEAR TREE HOUSE BOUGHT BY CHARLES HEWSON 9 ACRES. PRESENT TENANTS SINCE 1888

LOT 12 - HOUSE & LAND. TENANT - E.C. BRISTOWE BOUGHT BY SAME 6 ACRES

LOT 13 - COTTAGE - .751 ACRE BOUGHT BY MISS FANNY CANTY

LOT 14 - WHEELWRIGHT & CARPENTER'S TENANT & BUYER'S SHOP SHARP. 4 ACRES

LOT 15 - ROSE COTTAGE - TENANT & BUYER - ELLEN SAUNBY 3.5 ACRES FAMILY HAVE LIVED THERE 200 YEARS

LOT 17 - HOUSE & SHOEMAKER'S SHOP TENANT CHARLES CHAPMAN BUYER GEORGE SHARP. 24 ACRE £340

LOT 18 - TWO SEMI-DETACHED COTTAGES + GROCERY SHOP TENANT & BUYER GEO. SHEPHERD & ARON WILLIAM BRISTOWE. 79 ACRE £330

LOT 24 - COTTAGE - TENANT CHAPMAN - BUYER WM. CHAS. BRISTOWE. 348 ACRE £220

LOT 25 - COTTAGE - TENANT & BUYER WILLIAM OGG. 723 ACRE £250

LOT 20 - NORMANBY HOUSE FARM - 519 ACRES £4500

LOT 21 - THE GRANGE FARM 299 ACRES £3,600

LOT 22 - NORMANBY LODGE BRANT - 754 ACRES - £10,100

NOTE: This Plan is based upon the Ordnance Survey by permission of the Board of Agriculture and Fisheries, and the Controller of H.M. Stationery Office.

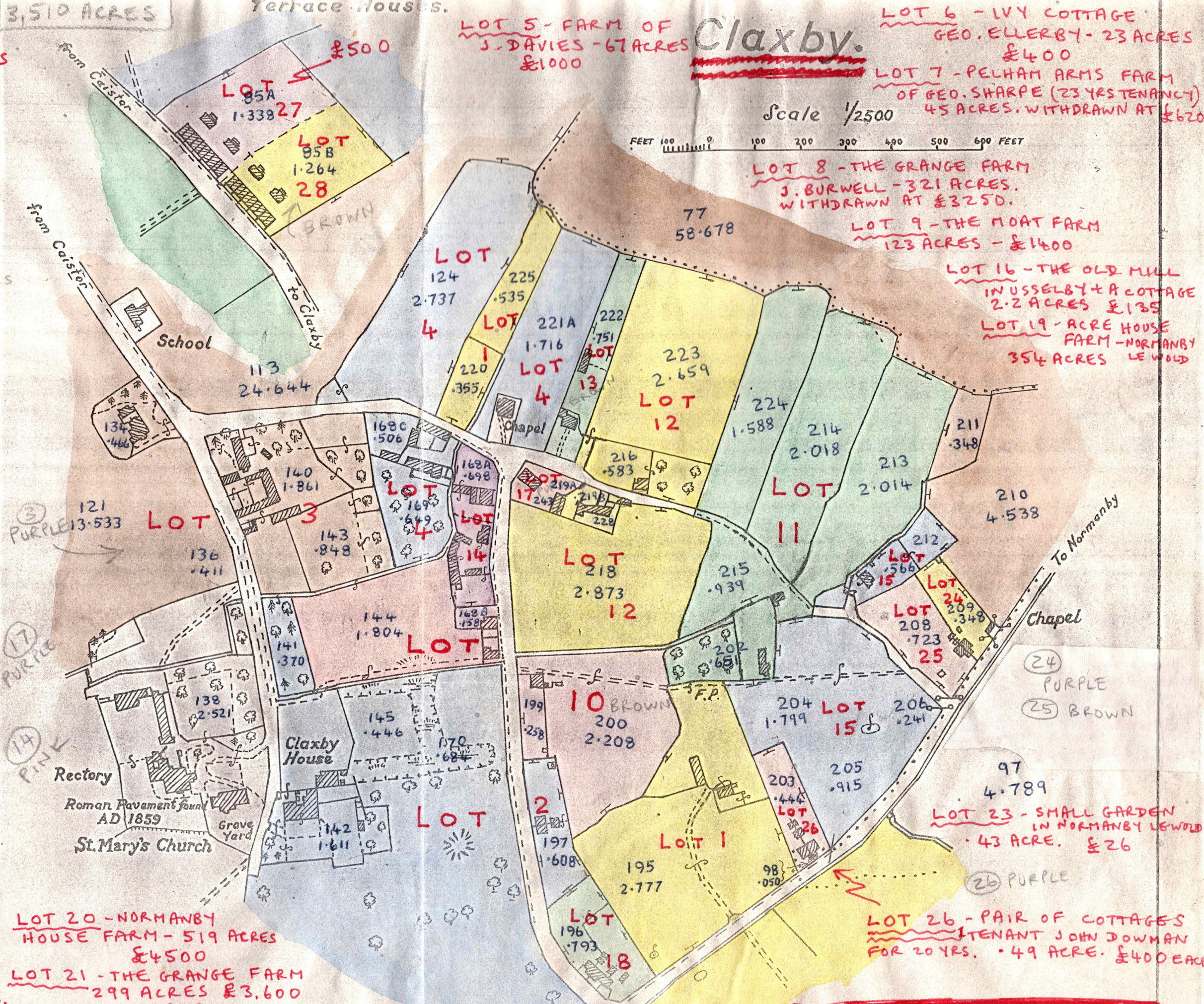

17th Sept. 1919
Map of Property Sale
by Earl of Yarborough